

B

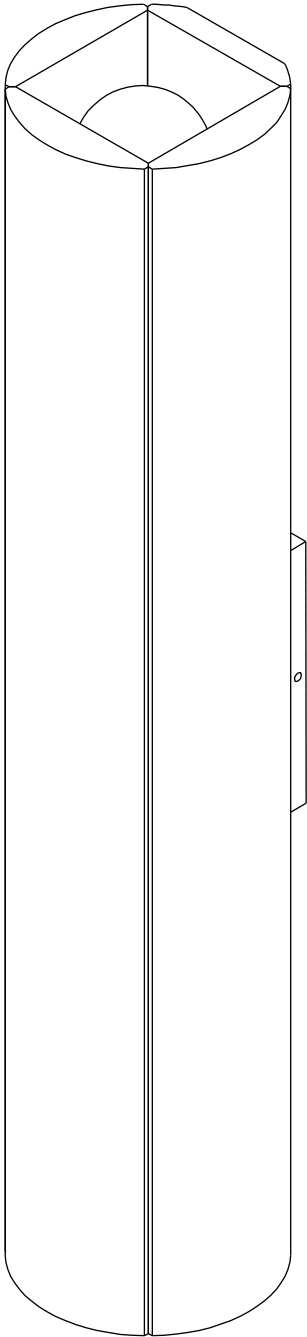

C

INSTALLATION OVERVIEW

PARTS + NOTES

- | | | |
|-------------------|------------------|---------------------------------------|
| A. Fixture | C. 3/32" Hex Key | E. Tala "Sphere I"
E12 LED bulb 2x |
| B. Mounting Plate | D. Wire Nuts 3x | F. Mounting Screws 2x |

CAUTION
Make sure building power is disconnected prior to handling wires. Installation should be done by a certified electrician.

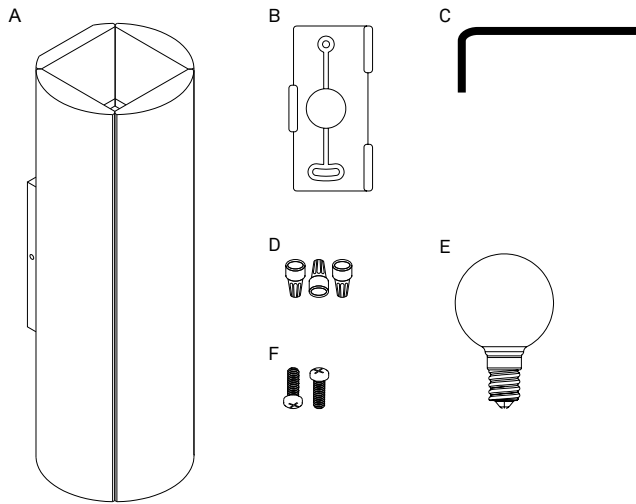

NOTE:

Mounts directly to a 2" x 4" Switch Box style junction-box.

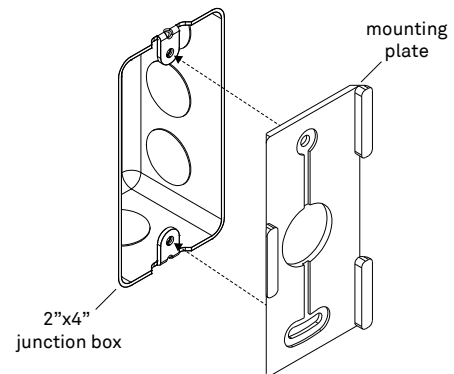

STEP 1

MOUNTING PLATE INSTALLATION

1.1 Mounting

Attach and level mounting plate (B) using provided screws (F). Bring wires through the center hole.

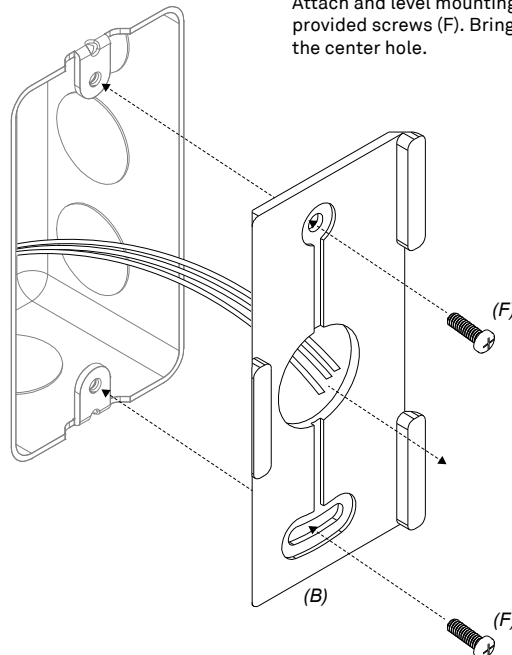

STEP 2**FIXTURE INSTALLATION**

CAUTION
Make sure building power is disconnected prior to handling wires. Installation should be done by a certified electrician.

2.1 Connect Wires

Connect white, black and green wires using wire nuts (D). Cap any extra wires in the j-box and tuck all wires through the central hole in the mounting plate.

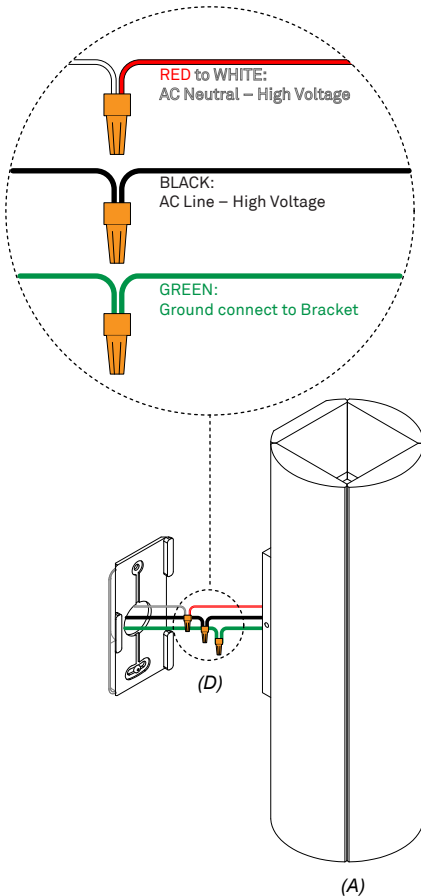
**2.2 Secure Fixture**

Place the fixture over the mounting plate. Secure by tightening the set screw from the side using the allen key (D).

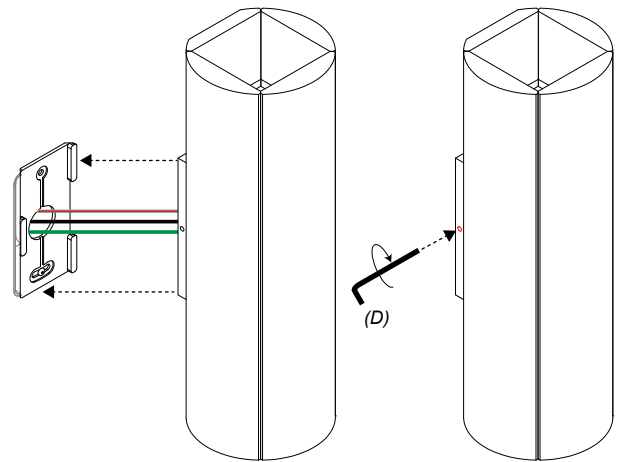
**2.3 Install Bulb**

Screw bulbs (E) into top and bottom of the fixture.

